



Set-up Instruction

The banner display are ideal to use for exhibitions, trade shows, conferences, promotional advertising or any where else where you need a display graphic with impact. A simple to use lightweight entry level display, No tools no parts to use. Graphics attach using eyelets so, the display banner stands are very simple to use.

Product Information

Graphic size (mm)	600 x 1600
Packaged weight	< 1Kg,
Material	aluminium alloy, plastic
Package	90 x ~10 x ~10

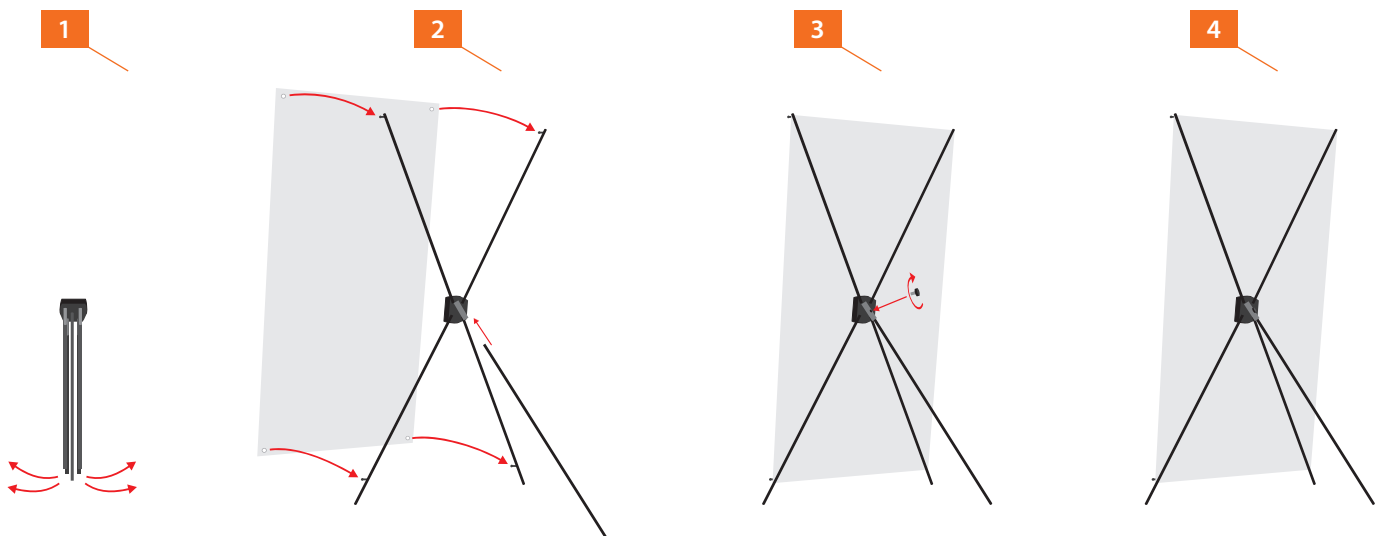

1 Fully open stand.

2 Hang the upside of the graphic on the screw holder of the support pole.

3 Screw holding leg.

4 Your counter is now ready.

Graphic Specification

These are guidelines for preparing ready printing files

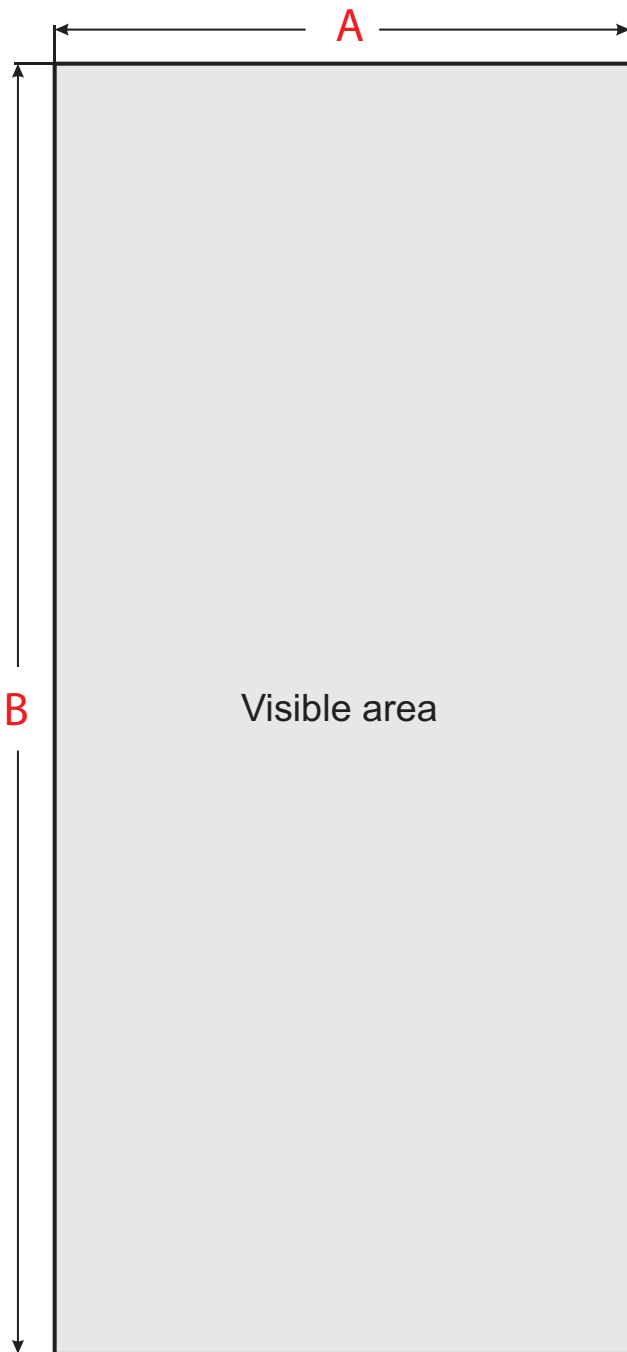

Artwork Guidelines

Visible graphic size (A x B)	600 x 1600
--------------------------------	------------

Artwork Requirements

Resolution	100-150 dpi
------------	-------------

Color mode	CMYK
------------	------

File format (scale M 1:1)	.TIFF
-----------------------------	-------

Recommendations

Keep all important graphic elements (images, text, etc.) within the visible area.

Please allow space for trimming by not placing type or logos too close to the edge of the visible area.